

TM-LCD FLAT-PANEL TECHMOUNT OWNERS MANUAL

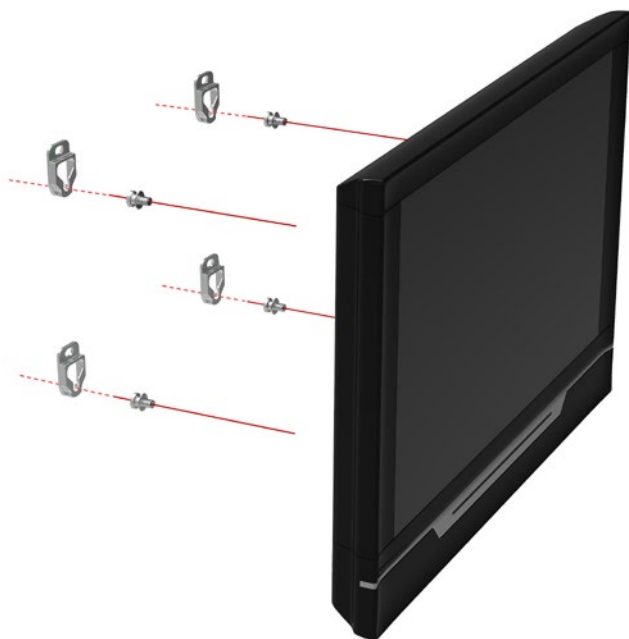

www.visionaudiovisual.com/techmount/tm-lcd

TM-LCD FLAT-PANEL TECHMOUNT OWNERS MANUAL

Thanks for choosing the Vision TM-LCD Techmount! In order to obtain the best performance please be sure to read this owner's manual and use your product only in accordance with the instructions.

WARNINGS

During installation take care to adhere to workplace health and safety laws:

- Attach the bracket to a rated load-bearing structure. It can be attached to brick/masonry walls.
- Do not cut or drill any parts above head height. This should all be done using the correct safety equipment at floor level.
- Avoid overstretching which might result in the ladder tipping over.
- SWL (safe working load): 4 X 12.5kg = 50kg



The TM-LCD is a flat-panel wall bracket which is designed to fix to a load-bearing wall. You should ensure the correct fixtures are used for the type of wall you are attaching to. The fixtures provided might not be appropriate for your wall.

- Ensure it is installed in an appropriate place – for example not obstructing an emergency exit.
- Check stability after installation.
- Installation must be done by a specialist audio-visual installer
- Avoid installing in a moist environment, or in direct sunshine, or near corrosive gas or liquid.
- Routing of cables through the bracket must comply with local regulations.
- Allow 1000mm x 1200mm space around the bracket.
- The viewing distance between user and screen must be adjustable depending on the size of the monitor and the display font (450mm at minimum).
- Avoid obscuring important information (i.e. traffic information) behind the panel.
- Installation and routing of monitor cables on the monitor bracket must comply with electro-technical regulations.
- Moving parts that are oily, greasy or have other lubrication must not cause contamination.
- Use a soft cloth to wipe clean. Do not use alcohol, organic solvents, or corrosive liquid.



ENSURE POWER CABLE IS NOT TWISTED, SQUEEZED, OR SHEARED!

All products are designed and imported into the EU by 'Vision' who is wholly owned by 'Azlan Logistics Ltd.', Registered in England Nr. 04625566 at Lion House, 4 Pioneer Business Park, Clifton Moor, York, YO30 4GH.



CONTENTS

- 3 x TM-LCD Wall Bracket (Zamak3, Painted Silver)
- 1 x TM-LCD Wall Bracket with threaded hole (Zamak3, Painted Silver)
- 1 x M4x30 Anti-theft screw (Strength grade: 4.8)

- 4 x M4×12 Finger Bolts (Q235, Nickle plated, strength grade: 4.8)

- 4 × ST8×50 Screws (Strength grade: 4.8, Zinc plating)
- 4 x M8 square washers (SPCC 1.5mm, Zinc plating)
- 4 × RT expansion tube 6.5×45 (HDPE)

- 4 × ST4×25 Cross-recessed Pan-head Self-tapping Screws (Strength grade: 4.8, Nickle plated)
- 4 x M4 square washers (SPCC 1.5mm, Zinc plating)
- 4 × RT expansive tube 4×30 (HDPE)

- 1 x Large Paper Template
- 1 x Small Paper Template
- 1 x Spirit Level with plastic clip

Optional Additional Bolt Kit (can be purchased separately):

- 4 x M5×12 Finger Bolts (Q235, Nickle plated)
- 4 x M6×14 Finger Bolts (Q235, Nickle plated)
- 4 x M8×16 Finger Bolts (Q235, Nickle plated)

INSTALLATION INSTRUCTIONS

SCREENS WITH VESA MOUNTING POINTS:

1. Identify VESA standard on the paper template that matches the screen.

Small screens will have mounting holes 100mm x 100mm apart in a square formation on the rear. This layout will be found on the small paper template included.

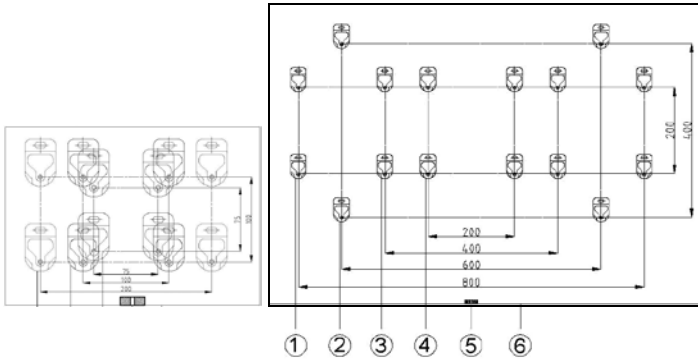

2. Stick the paper template to the wall where you want to mount the screen using the spirit level to make it level. Consider the position so that fixtures will be anchored to load-bearing structures.
3. Attach the 4 x TM-LCD mounts to the wall using appropriate fixtures.

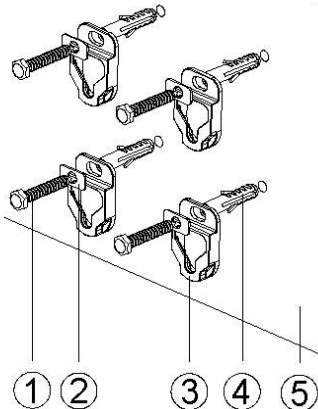

1. ST8×50 Screw
2. M8 Square Washer
3. TM-LCD Bracket
4. RT expansion tube 6.5×45
5. Wall

To install lightweight flat panels (<10kg) use ST4×25 screws. For heavier flat panels (>10kg) user ST8×50 screws.

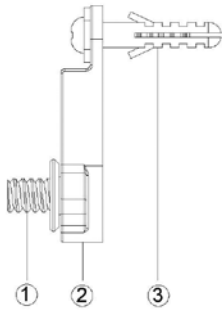

1. Finger Bolts
2. TM-LCD Bracket
3. RT expansion tube 4×30

4. Using fingers screw 4 x finger bolts included into the mounting points on the rear of screen. Turn until finger-tight.

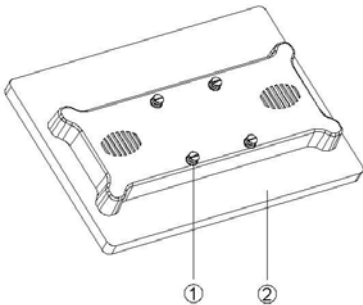

1. Finger Screws
2. Monitor

NOTE: SOME SCREENS HAVE RECESSED MOUNTING POINTS WHICH THE INCLUDED BOLTS MAY NOT BE LONG ENOUGH TO REACH. FOR SMALL SCREENS (20-39") ENSURE YOU HAVE TURNED THE BOLTS INTO THE SCREEN MOUNTING POINTS AT LEAST 5 TIMES. FOR LARGE SCREENS (40" +) ENSURE YOU HAVE TURNED THE BOLTS AT LEAST 10 TIMES.

5. Hang the screen on the wall mounts.

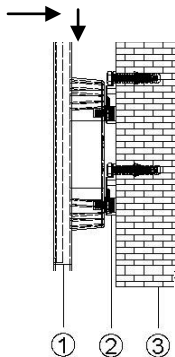

1. LCD monitor
2. TM-LCD bracket
3. Wall

A locking screw is included to prevent theft.

To detach screen remove locking screw and lift screen off brackets.

SCREENS WITH NON-VESA MOUNTING POINTS:

1. Carefully lay the screen face-down. Put the large paper template over the back of the screen, and mark on it the centre of the four mounting points.

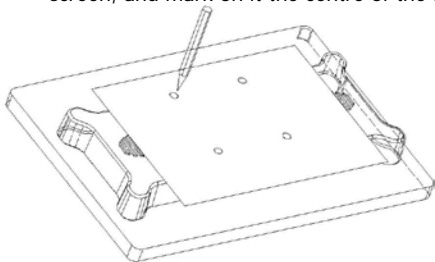

2. Stick the paper template to the wall where you want to mount the screen using the spirit level to make it level. Consider the position so that fixtures will be anchored to load-bearing structures.
3. Attach the 4 x TM-LCD mounts to the wall following the steps 3-5 on the previous pages. The brackets should be positioned so that the marks you made on the template are visible at the bottom of the keyhole on the TM-LCD wall mount.

SPECIFICATIONS

Bracket dimensions: 56 x 36 x 10mm

Weight: 310g

WARRANTY

This product comes with a 2-year return to base warranty, effective from the date of purchase. This warranty applies only to the original purchaser and is not transferable. For the avoidance of doubt, this will be taken from the information held by the appointed national distributor at the point of sale. The liability of the manufacturer and its appointed service company is limited to the cost of repair and or replacement of the faulty unit under warranty, except for death or injury (EU85/374/EEC). This warranty protects you against the following:

- Faulty welds resulting in the product not safely performing its task within the recommended SWL (safe working load).
- Poor finishing resulting in the product not being able to be assembled.
- External corrosion if identified within 24 hours of purchase. Some parts of the product are not powder-coated or painted so light corrosion may develop over time. This is normal and does not adversely affect the load-bearing capability of the product, therefore it is not covered in this warranty.

If you find you do have a problem with this product, you should contact the AV reseller you purchased this product from. The original purchaser is responsible for shipment of the product to the manufacturer's appointed service centre for repair. We will endeavour to return repaired units within 5 working days, however this may not always be possible in which case it will be returned as soon as practically possible. This warranty does not protect this product against faults caused by abuse, misuse, or incorrect installation which might be caused by ignoring the guidelines set out in this manual. If failure is not covered by this warranty, the owner will be given the option to pay for labour and parts to repair the unit at the service company's standard rate.

LEGAL DISCLAIMER: Because we are committed to improving our products, the details above may change without prior warning. This User Manual is published without warranty and any improvements or changes to the User Manual necessitated by typographical errors, inaccuracies of current information, or improvements to programs and/or equipment, may be made at any time and without notice. Such changes will be incorporated into new editions of the User Manual.