

Digital Signage HDMI-over-IP Matrix



TC-MATRIX EU SAP: 4631209 US SAP: 13293711

TC-MATRIXRX EU SAP: 4631210 US SAP: 13293566

vav.link/tc-matrix

Transmits HDMI over a network or Point-to-Point
Plug-and-Play; no PC necessary for basic setup
4K @ 60Hz (H.264)
Supports video walls up to 3x3

Designed for video transmission applications the Techconnect Matrix allows distribution of HDMI content over an existing LAN infrastructure. You simply need a transmitter for each source, and a receiver for each display.

SETUP NOTE: The first time you connect source PC to Tx, drop refresh rate on PC to establish handshake. Once it is working restore refresh rate.



Switch / Distribute / Matrix

This product uses an IP network to distribute, switch, or matrix. It can have up to 100 x transmitters, and 100 x receivers.



Managed Switch

A "layer-3" switch is required with IGMP snooping turned on to allow multicasting. You don't need to know what this means, but it is essential it is turned on.



Shared Subnet

All end points must be on the same sub-net.

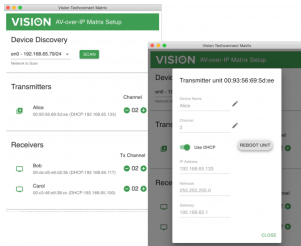

4Kx2K

With a maximum transfer rate of 18 Gbps and using H.264 compression this system supports 4K.

Point-to-Point

You can connect a transmitter directly to a receiver with a CAT6 cable and use it as a simple extender. Maximum cable length up to 120 m (394 ft).

Scaleable

Whether you need a small system or a large system; just buy what you need. When your system needs to grow just add more end points. Transmitters and receivers are sold separately.



Easy Setup and Switching

Each transmitter and receiver should be set to a unique channel on the front panel. Adjust the "TX Connected" channel on each receiver to select the target transmitter. Use the buttons on the front panel or the included remote control to change channels.

Advanced Software

Setup software is included for Mac and PCs. It scans for devices and allows the integrator to set device name, channel and IP address.

Video Wall Presets

Supports up to 3x3 video walls. Enter video wall mode and choose from 3x3, 3x2, 3x1, 2x2, 2x3, 1x3. Fine tune with bezel adjustment.

IR Passback

The system supports IR passback so source devices can be controlled remotely. IR emitter and receiver cables are included with each device.

Crestron and AMX drivers

Designing a system controlled by a Crestron or AMX control system is easy.

VISION

Hot Swap

If a device needs swapping simply replace it and set the channel on the new device to match the old device. IP and Mac addresses don't need to be modified.



VISION

MANUAL

Manual

EN PDF 1.80 MB

files.visionaudiovisual.com/products/TC-MATRIX/manuals/TC-MATRIX_manual_en.pdf

SOFTWARE

AMX drivers

ZIP 5.91 MB

files.visionaudiovisual.com/products/TC-MATRIX/software/TC-MATRIX_AMX_drivers.AXW

Crestron drivers

ZIP 2.36 MB

files.visionaudiovisual.com/products/TC-MATRIX/software/TC-MATRIX_Crestron_drivers.zip

TechconnectMatrix setup software

ZIP 156.50 MB

files.visionaudiovisual.com/products/TC-MATRIX/software/TechconnectMatrix_setup_software.zip

IMAGE

Product Images

ZIP 3.57 MB

<files.visionaudiovisual.com/products/TC-MATRIX/images/TC-MATRIX.zip>

Product Images

PNG 913.21 KB

<files.visionaudiovisual.com/products/TC-MATRIX/images/TC-MATRIX.png>

Product Images

PNG 645.12 KB

<files.visionaudiovisual.com/products/TC-MATRIX/images/TC-MATRIXRX.png>

Front

PNG 560.36 KB

files.visionaudiovisual.com/products/TC-MATRIX/images/TC-MATRIX_front.png

Product Images

PNG 608.00 KB

<files.visionaudiovisual.com/products/TC-MATRIX/images/TC-MATRIXTX.png>

Setup software

PNG 284.76 KB

files.visionaudiovisual.com/products/TC-MATRIX/images/TC-MATRIX_setup_software.png

Menu

PNG 387.09 KB

files.visionaudiovisual.com/products/TC-MATRIX/images/TC-MATRIX_menu.png

Stacked

PNG 765.56 KB

files.visionaudiovisual.com/products/TC-MATRIX/images/TC-MATRIX_stacked.png

SPECIFICATIONS

PRODUCT DIMENSIONS

164 x 108.5 x 23.6 mm / 6.46" x 4.27" x 0.93" (length x width x height)

PACKAGED DIMENSIONS

357 x 153.5 x 85 mm / 14" x 6.04" x 3.35"

PRODUCT WEIGHT

330g / 0.73 lb

PACKAGED WEIGHT

0.8kg / 1.76 lb

CONSTRUCTION MATERIAL

Metal

COLOUR

Black

INPUT AND OUTPUT TMDS SIGNAL

0.7-1.5 volts p-p

INPUT AND OUTPUT DDC SIGNAL

5 volts p-p (TTL)

MAXIMUM VIDEO FORMAT SUPPORTED

4K

OUTPUT VIDEO

HDMI 2.0 with HDCP 2.2

OUTPUT AUDIO

PCM

COMPRESSION

H.264

INPUT AND OUTPUT HDMI CABLE LENGTH

5m (16.4 ft) AWG 26

VIDEO LATENCY

< 500 Ms

SWITCH TIME

approx 5 seconds (caused by HDCP handshake)

OPERATING TEMPERATURE RANGE

0-50°C

STORAGE TEMPERATURE RANGE

-10-70°C

OPERATING HUMIDITY RANGE

0 to 90 % no condensation

REFRESH RATES SUPPORTED

24, 25, 30, 60Hz

TX POWER CONSUMPTION

7 watts

RX POWER CONSUMPTION

10 watts

CAT6 MAXIMUM DISTANCE (IF CONNECTED PEER-TO-PEER DIRECTLY)

120 m (394 ft)

IR PASSBACK BANDWIDTH

20-60 kHz

ESD PROTECTION

1a Contact discharge level 3 / 1b Air discharge level 3 (Standard: IEC61000-4-2)

CONNECTIVITY

1 x HDMI (type A) 1 x Ethernet (RJ45) 1 x DC Power (2-port phoenix) 1 x 3.5mm Minijack (IR)

POWER SUPPLY

100-240v 50/60Hz AC 5 volt / 3 amp

TRANSFORMER INTEGRATED INTO PLUG

INCLUDES INTERCHANGEABLE PLUGS

UK/EU/US/AU

DC TAIL LENGTH

1.8m

TRANSFORMER DIMENSIONS

81 x 52 x 38mm / 3.2" x 2.05" x 1.5"

ACCESSORIES INCLUDED

2 x Mounting ears 1 x Remote Control 1 x IR Emitter Cable 1 x IR Receiver Cable

WARRANTY

Lifetime return-to-base

COMPLIANCES

RoHS, WEEE, CE/EMC

ORDER PART CODE

Transmitter TC-MATRIXtx [EU SAP: 4631209 / US SAP: 13293711] Receiver TC-MATRIXRx [EU SAP: 4631210 / US SAP: 13293566]

SPARE POWER SUPPLY UNIT (PSU)

tbc [SAP:]

